

# Assembly Guide

## Tall Cabinet

Model# RTA361872-BLK

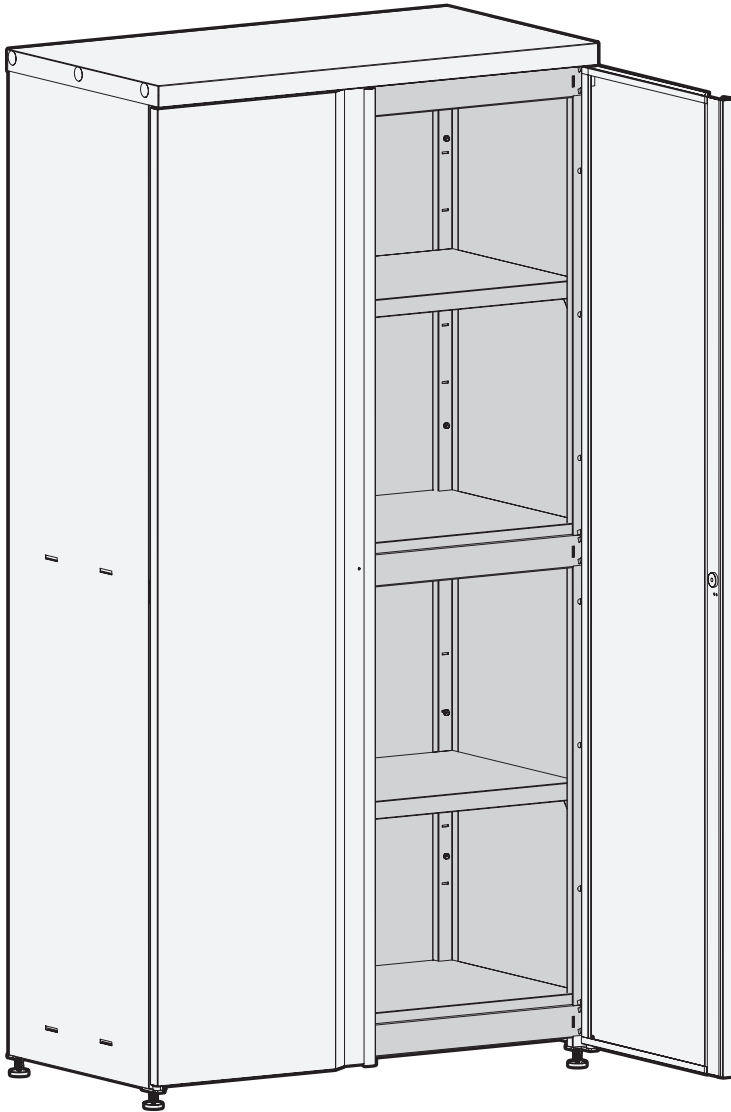

EDSAL MANUFACTURING CO, LLC  
1555 W. 44TH STREET  
CHICAGO, IL 60609  
[www.edsal.com](http://www.edsal.com)

# CONTENTS

CONTACT US. . . . .	2
SAFETY INFORMATION . . . . .	3
SPECIFICATIONS . . . . .	3
WARRANTY . . . . .	3
PRE-INSTALLATION . . . . .	3
PACKAGE CONTENTS. . . . .	4
ASSEMBLY . . . . .	5
PARTS LIST . . . . .	12
MAINTENANCE AND CARE. . . . .	13
CUSTOMER FEEDBACK SURVEY . . . . .	13

# CONTACT US

Questions, problems, missing parts? Contact us directly for assistance:  
7 a.m. - 5 p.m., CST, Monday-Friday

**Chat:** [www.edsal.com](http://www.edsal.com)  
**Email:** [support@edsal.com](mailto:support@edsal.com)  
**Phone:** 1-773-475-3131

To obtain replacement parts please provide:

**Model Number:** \_\_\_\_\_

**Description:** \_\_\_\_\_

**Date of Purchased:** \_\_\_\_\_

THANK YOU FOR YOUR PURCHASE

# SAFETY INFORMATION

- This product is intended for indoor use only.
- This product is not designed for commercial or industrial usage.
- Use at least two people to assemble and move this product. Failure to do so can result in personal injury or product damage.
- Any assembly or maintenance of this product must be carried out by adults only.
- Keep the product on a level surface. The product could become unstable and may tip over if stored or moved on an uneven surface, which may cause product damage, personal injury, or death.
- Do not leave children unattended near this product. Cabinet can tip over if improperly opened.
- DO NOT stand on this product or use it as a ladder or scaffold.
- DO NOT alter this product in any manner.
- DO NOT put anything on the top panel of this product.
- Do not exceed the maximum load capacity for each shelf and the entire unit.
- Retain this manual for future reference.

 **Warning:** To reduce the risk of serious injury, read and follow the safety instructions before assembling and using this product.

# SPECIFICATIONS

- Cabinet Dimensions: 36 in. W x 18 in. D x 72 in. H
- Maximum load capacity for each shelf and bottom level: 300 lbs. / 136 kg
- Maximum load capacity for the entire unit: 1200 lbs. / 544.3 kg

# WARRANTY

Edsal Manufacturing Company, LLC products are guaranteed for a period of one (1) year from the date of purchase. The SOLE AND EXCLUSIVE REMEDY for such defects is the repair or replacement of a defective product or parts thereof by Edsal Manufacturing Company, LLC or, at Edsal Manufacturing Company, LLC option, refund of the purchase price upon return of the item to Edsal Manufacturing Company, LLC. This warranty shall not apply in the event the products are damaged as a result of misuse, neglect, accident, moisture, improper application, improper assembly, or assembly not in conformity with the instructions of Edsal Manufacturing Company, LLC, failure to abide by safety precautions prescribed by Edsal Manufacturing Company, LLC or modification or repair by persons not authorized by Edsal Manufacturing Company, LLC.

# PRE-INSTALLATION

- Begin by placing the package on a flat surface. Use a rug to protect the cabinet and floor.
- Remove all parts and dispose/recycle all packaging materials.
- Check to make sure all parts are present.

## Tools Required (not included)

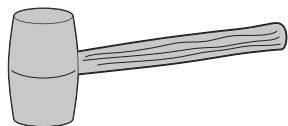

Rubber Mallet or Soft Face Hammer

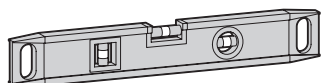

Level

**Note:** If using a hammer, a cloth should be used over the parts to protect the paint.

# PACKAGE CONTENTS

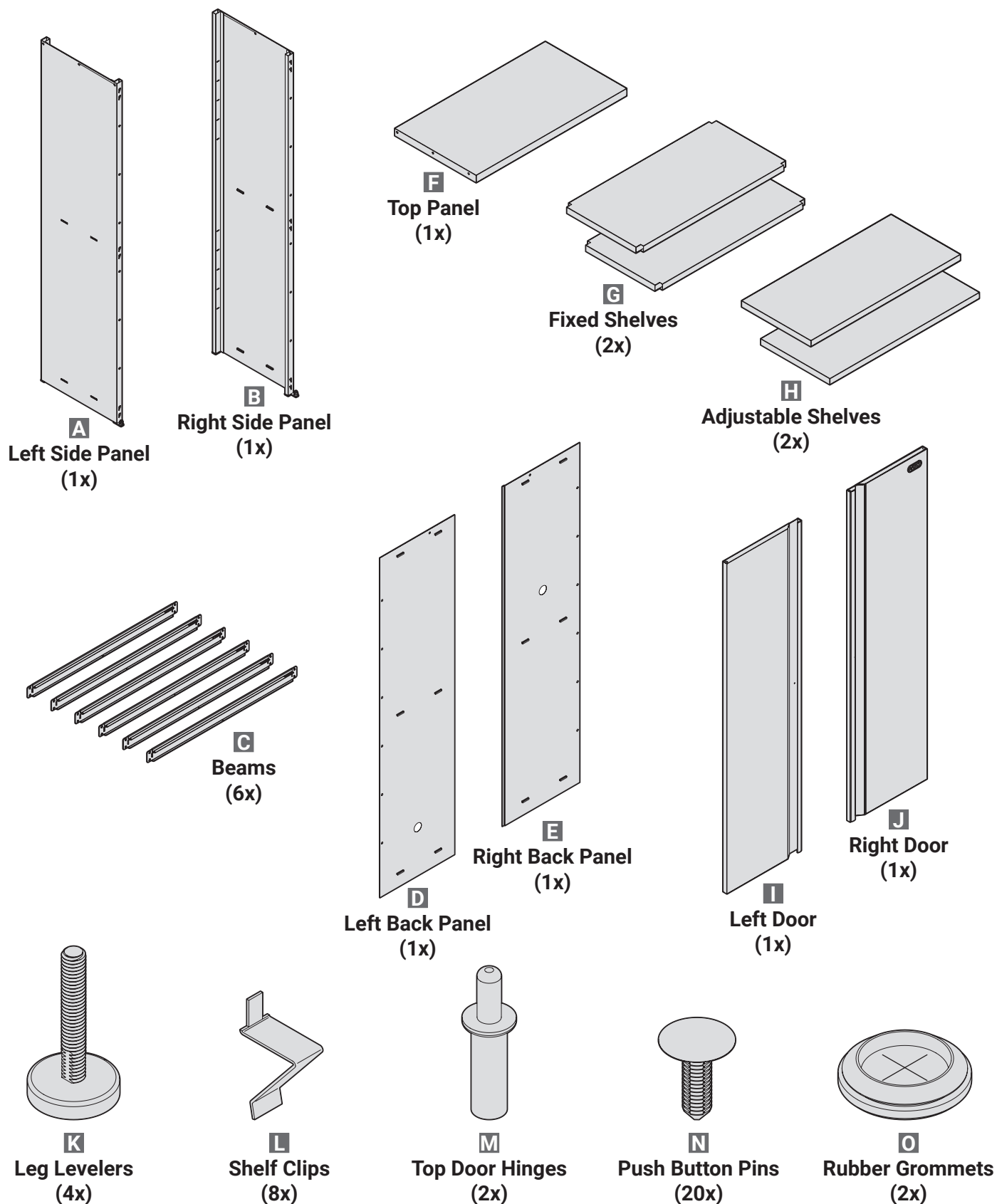

# ASSEMBLY

## STEP 1 Install Leg Levelers

- Insert Leg Levelers (K) into the bottom holes of Left Side Panel (A).
- Insert Leg Levelers (K) into the bottom holes of Right Side Panel (B).

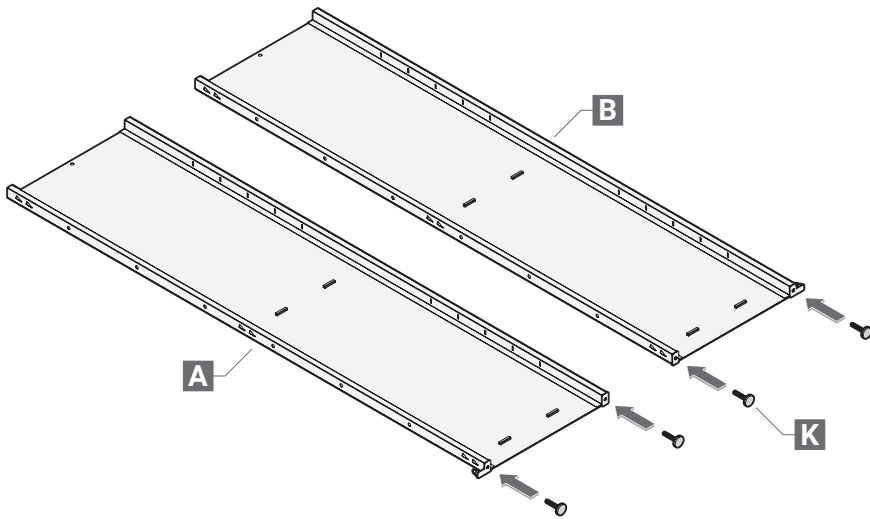

**Note:** Screw leg levelers all the way in.

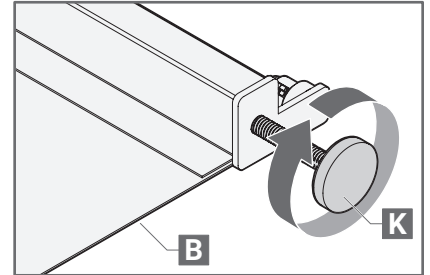

## STEP 2 Install Beams

- Assemble the middle two beams first, then the bottom two beams, and finally the top two beams.
- Install two Beams (C) to the middle section of the front and back of Side Panels (A) and (B).
- Insert the two end tabs on each side of the beam into the two slots of each side panel. Ensure the tabs are facing down and the ledge is facing up.
- Using a rubber mallet or a hammer covered with a cloth lightly tap downward on the beams to secure the tabs.
- If the beams pop up press the tabs inward for a tighter fit.

**Tip:** Recommended two-person assembly for this step.

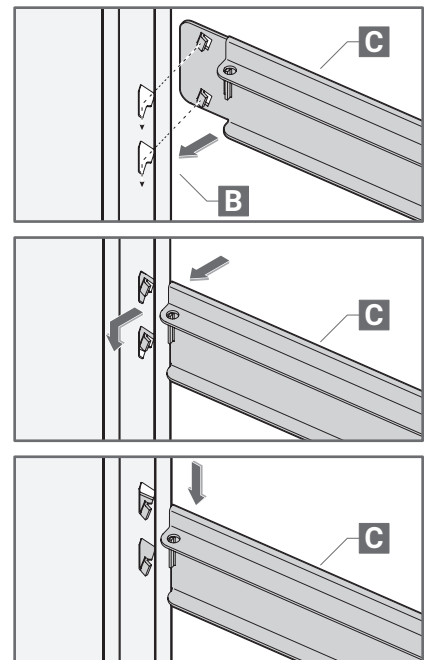
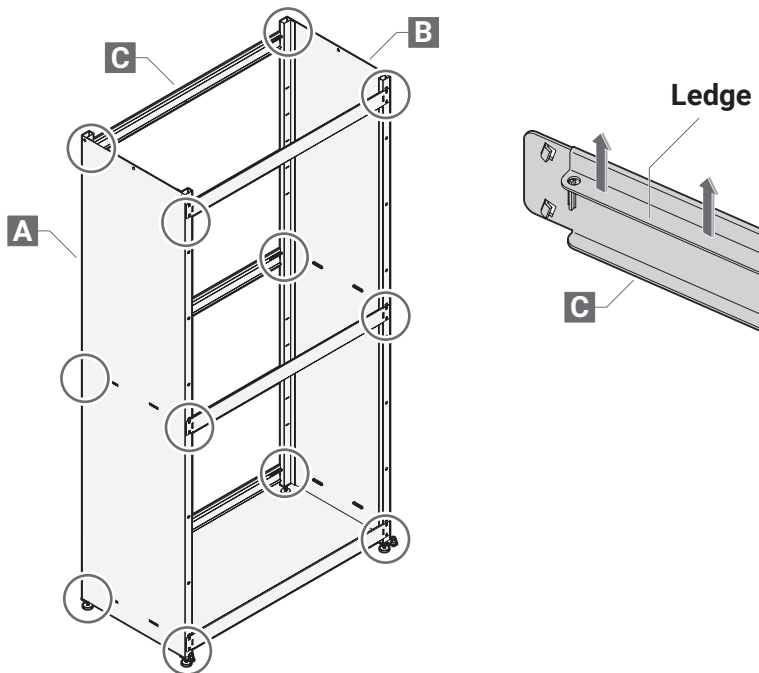

### STEP 3 Install Back Panels

- Attach the Left Back Panel (D) and Right Back Panel (E) onto the back of each beam by the tab hooks on the top, middle, and bottom of the panels (D and E).
- Attach Left Back Panel (D) first and the Right Back Panel (E) second to ensure the flange on the Right Back Panel (E) overlaps the Left Back Panel (D).
- Ensure all the tab hooks are fully attached to each beam.

**Note:** There are six total inner tab hooks per back panel, located at the top, middle and bottom to attach onto each beam level.

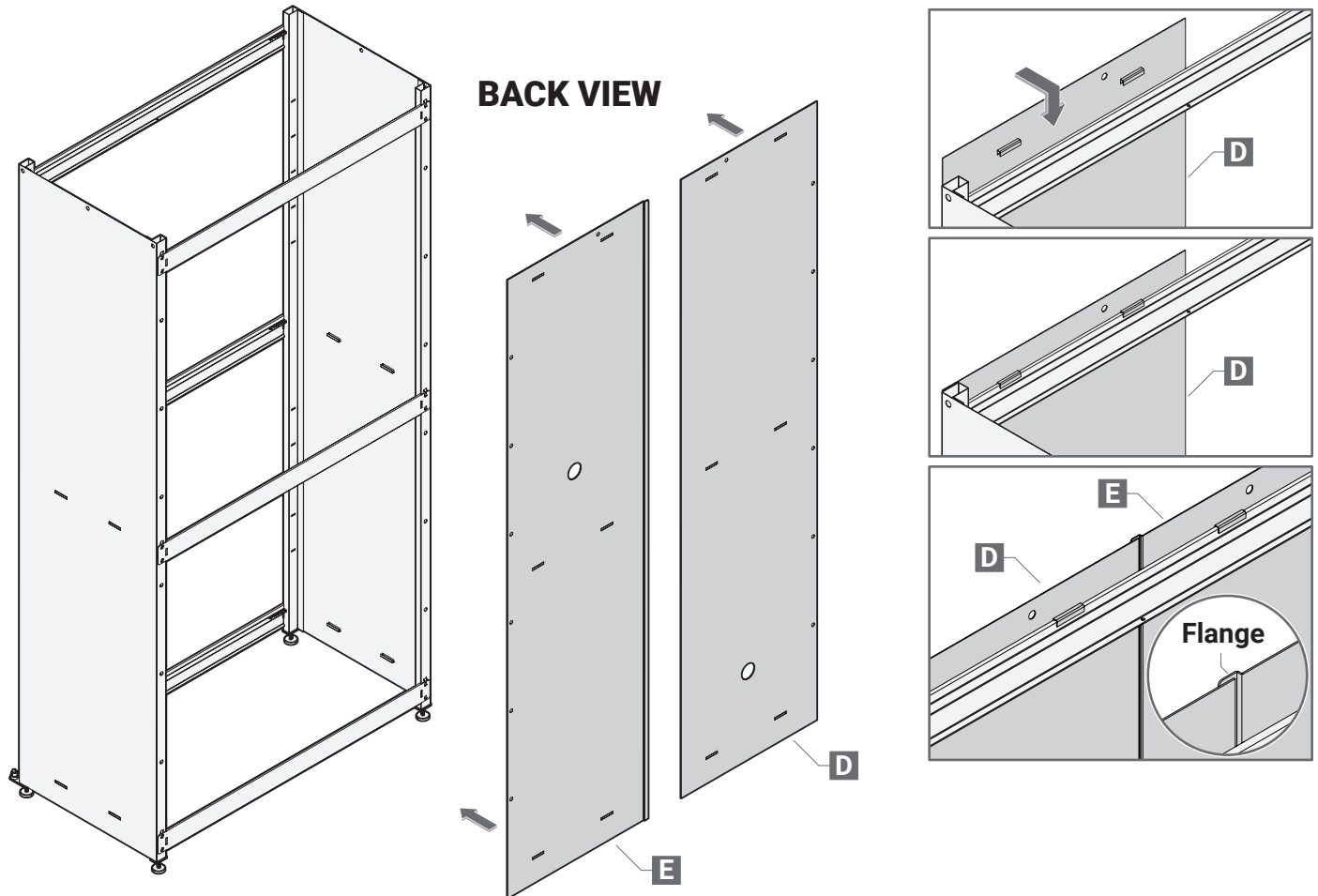

## STEP 4 Install Top Panel

- Place the Top Panel (F) over the side and back panels with the flange facing the front and be seated behind the Beam (C).
- Make sure the back edge of the Top Panel (F) is placed on the outside of the Left Back Panel (D) and Right Back Panel (E).

**Note:** The long flange must face the front and be seated behind the beam.

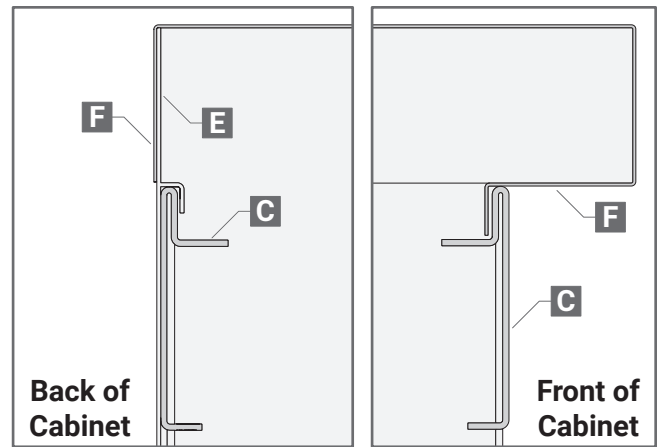
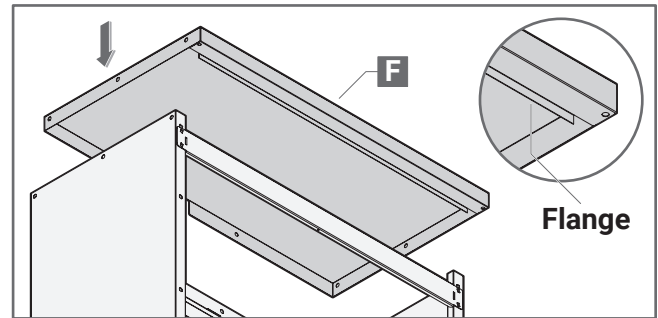
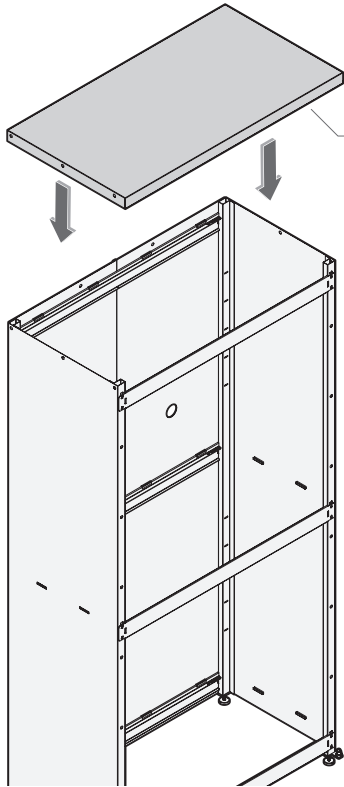

## STEP 5 Install Push Button Pins

- Make sure all holes from the back panel align with the holes from the side panels.
- Using a rubber mallet gently tap the Push Button Pins (N) into the 12 holes on the back panel. There are six holes on each side.

**Tip:** If the holes are not all aligned, slightly nudge the panels until fully aligned.

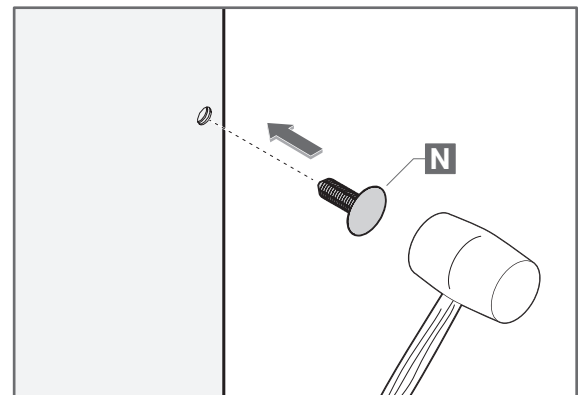
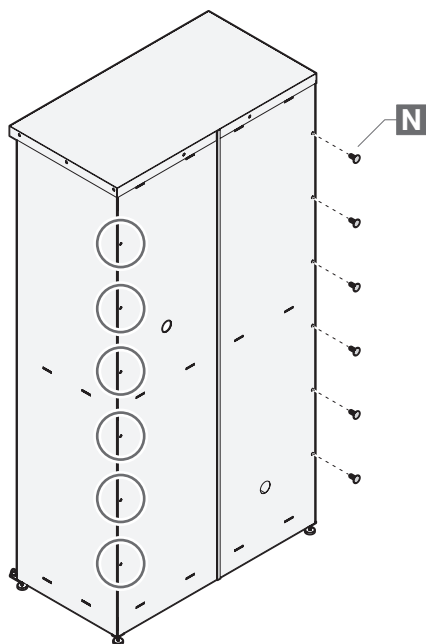

## STEP 6 Install Shelves

### Install Fixed Shelves

- Insert the Fixed Shelf (G) in the bottom at an angle.
- Lower the shelf onto the beams and the side panel tabs. Press the side panels inwards from the outside to engage the tabs on the side panels.
- Press down gently to secure the shelf.
- The shelf should sit at a leveled position.

**Tip:** Insert shelves into the cabinet at an angel.

**Note:** Repeat steps for middle shelf.

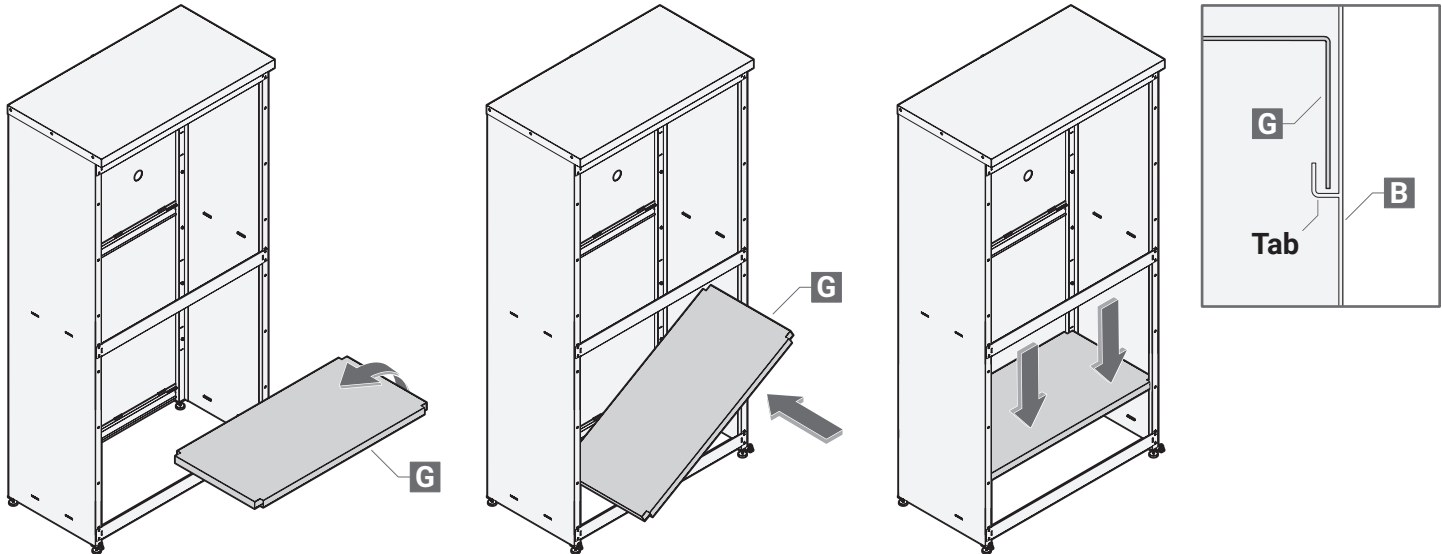

### Install Adjustable Shelves

- Insert the Shelf Clips (L) into the slots at the same height on all four sides.
- Insert the Adjustable Shelf (H) at an angle then lower the self on the shelf clips.
- If the shelf does not sit level adjust the clips until the clips are at the same height.

**Note:** Repeat steps for second shelf.

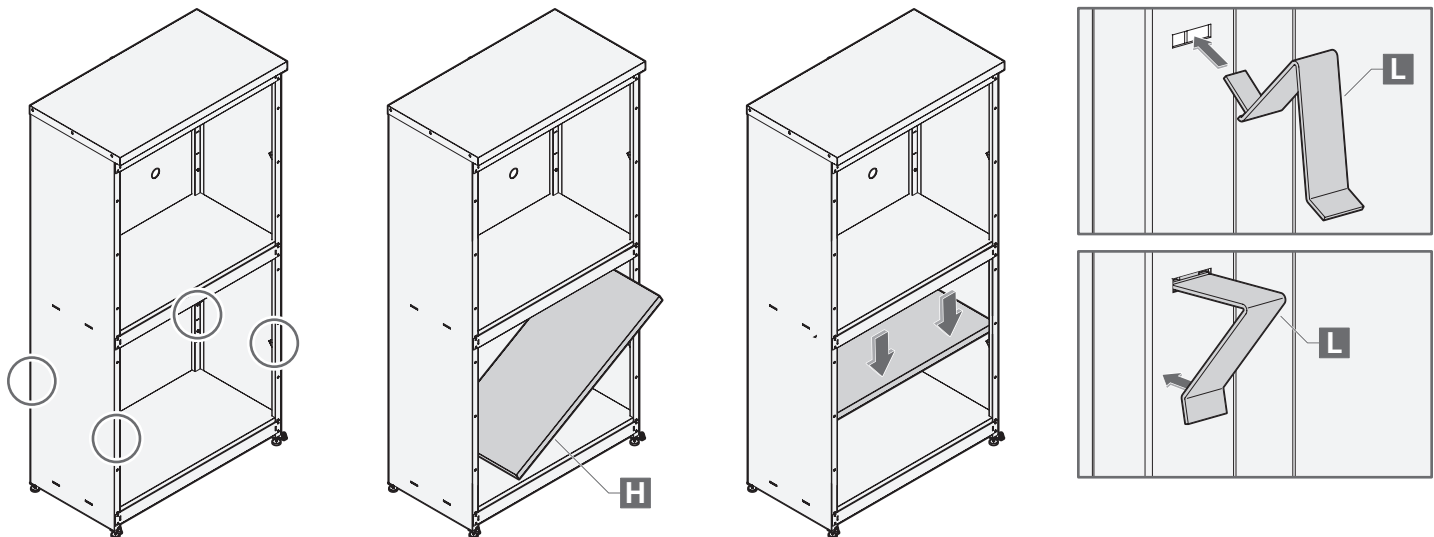



## STEP 7 Install Top Door Hinges

- Insert the Top Door Hinges (M) into the holes on the top of the Left Door (I) and the Right Door (J).

**Note:** The door hinges should be placed with the spring loaded side facing up.

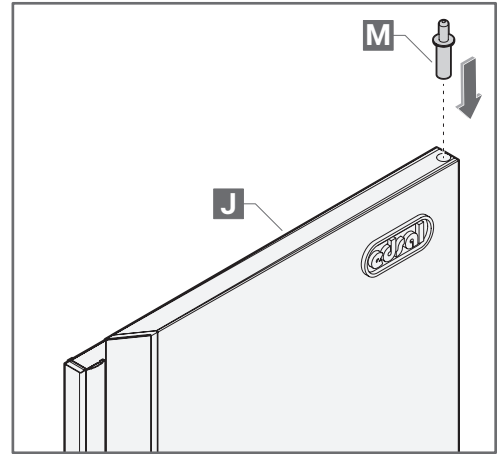
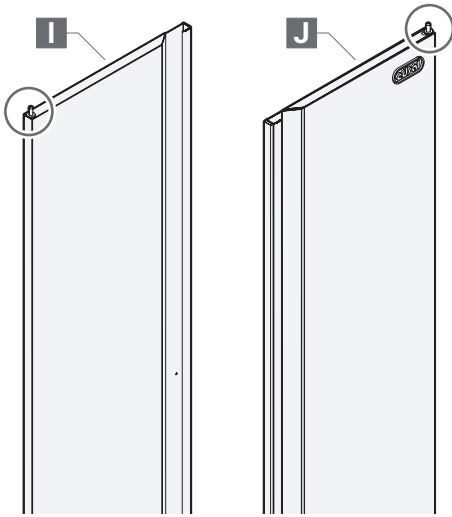

## STEP 8 Install Doors

- Install the Left Door (I) and Right Door (J) starting from the bottom.
- Locate the hole at the bottom of the door.
- Place the hole over the hinge located on the bottom of the side panel.
- Insert the top door hinge into the top panel by pressing down on the hinge and lifting up the top panel slightly.
- Push the top panel down to secure the door.

**Tip:** The top door hinge is spring loaded and can be pressed down to help insert into the top panel hole.

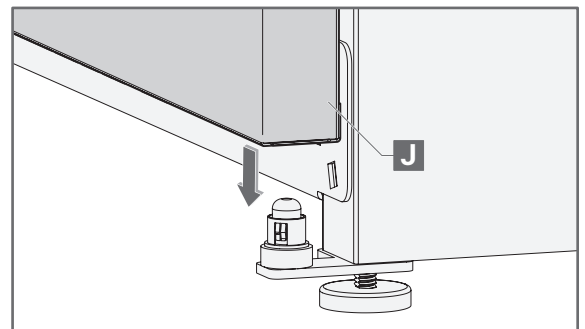
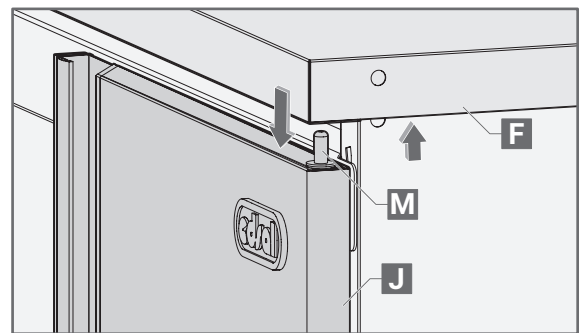
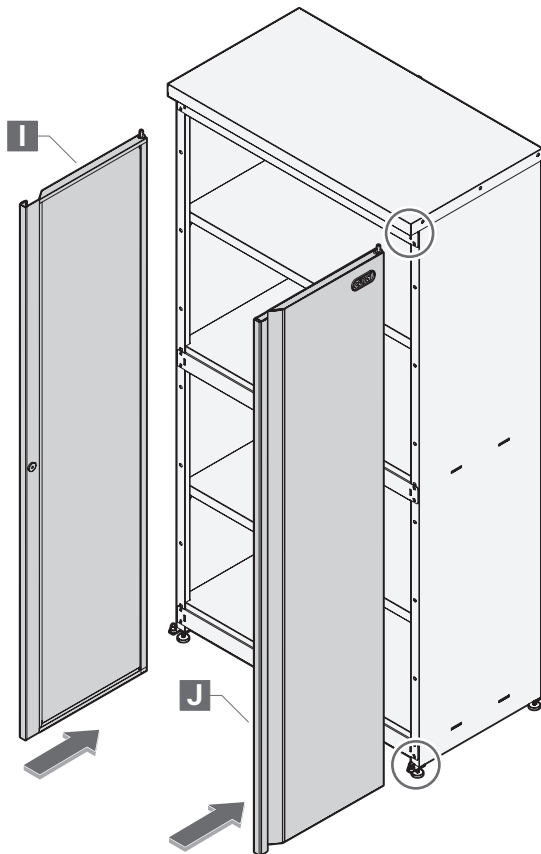

## STEP 9 Install Push Button Pins

- Ensure all holes from the top panel, back panel, and side panels are aligned.
- Using a rubber mallet gently tap the eight Push Button Pins (N) into the holes.

**Tip:** If the holes are not all aligned, try slightly nudging the panels until fully aligned.

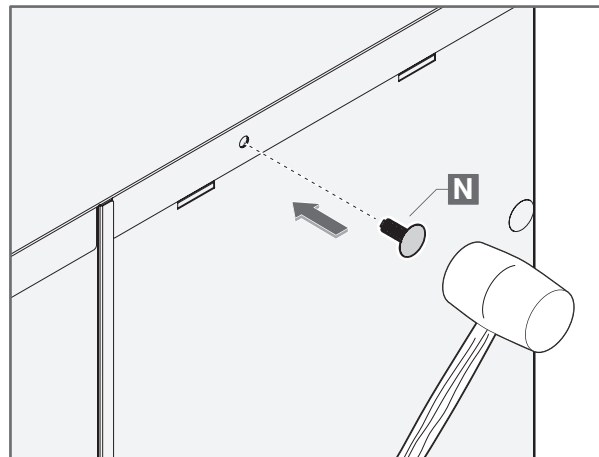
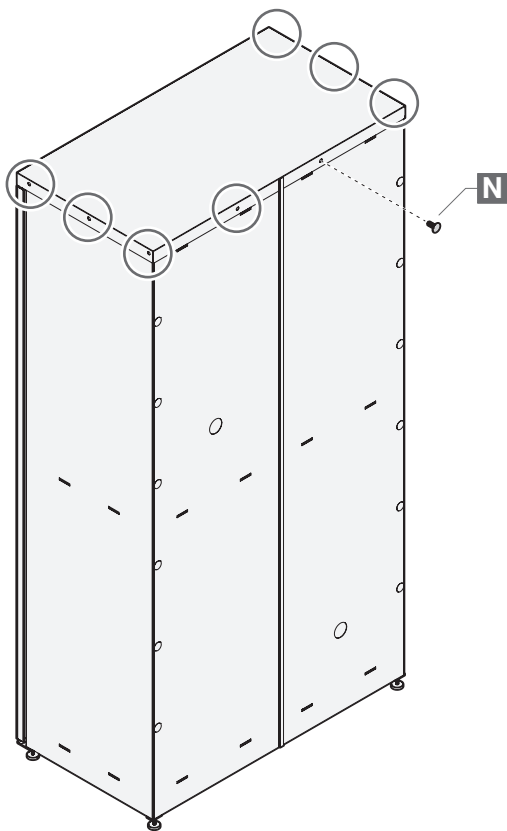

## STEP 10 Install Rubber Grommets

- Install the two Rubber Grommets (O) into the two holes located on the back panels.

**Tip:** Puncture a hole through the "X" located on the grommets to allow for easy cords access.

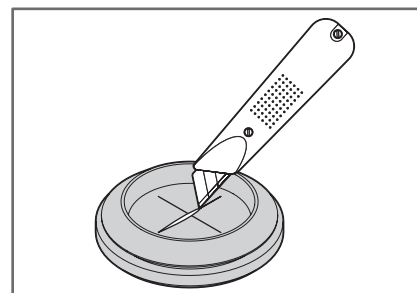
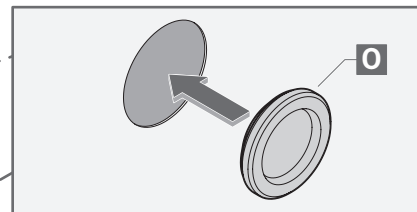
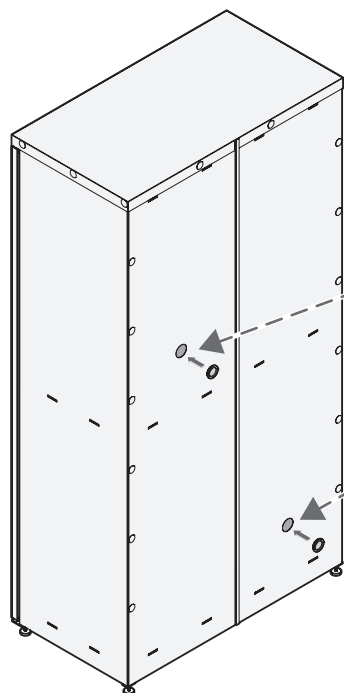

## STEP 11 Final Inspection

- Check to make sure the cabinet is leveled in its final location, using a leveler.
- Adjust the leg levelers if necessary.

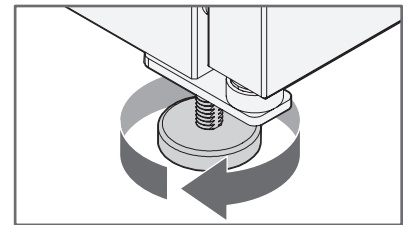
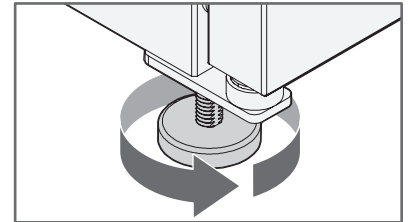
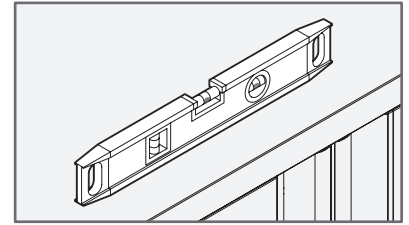
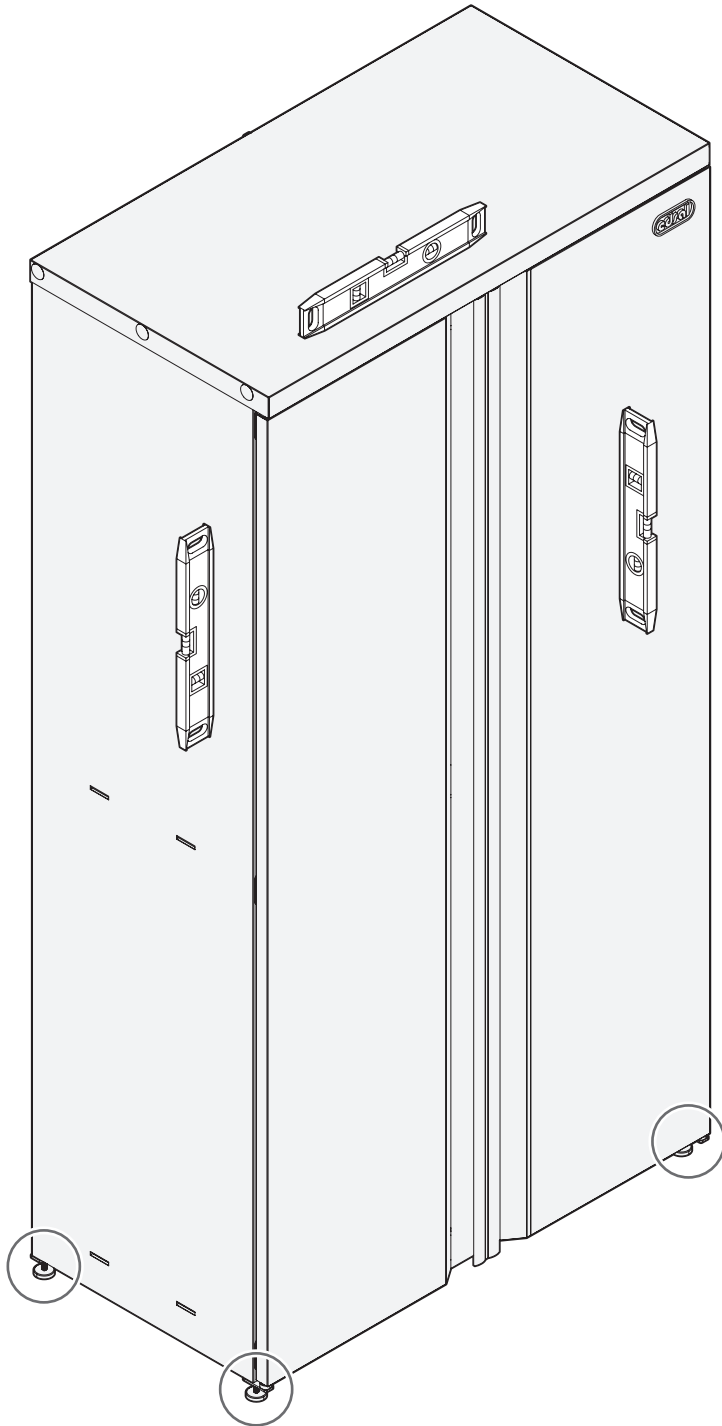

# PARTS LIST

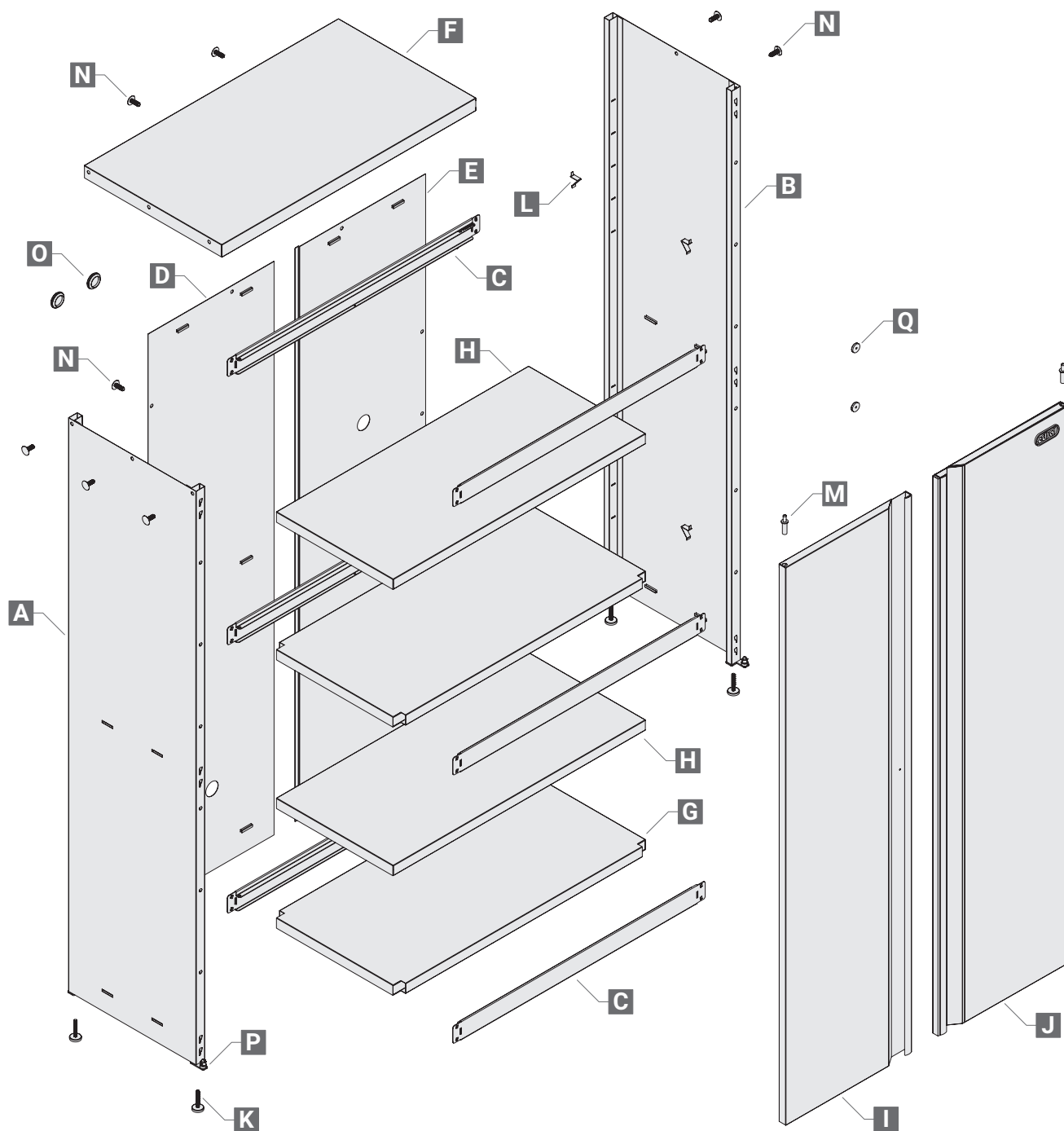

Part	Description	Qty	Part Number
A	Left Side Panel	1	ASS7218-L
B	Right Side Panel	1	ASS7218-R
C	Beam	6	N2R-BM36-BLK
D	Left Back Panel	1	ABKL7217
E	Right Back Panel	1	ABKR7218
F	Top Panel	1	AAT3618
G	Fixed Shelf	2	ASF3618
H	Adjustable Shelf	2	ASA3618
I	Left Door	1	ADR7218-L
J	Right Door	1	ADR7218-R

Part	Description	Qty	Part Number
K	Leg Leveler	4	RTALLGVL
L	Shelf Clip	8	SCLIP-STD
M	Top Door Hinge	2	HNG-TOP
N	Push Button Pins	20	RTA-PUSHBUTTON
O	Rubber Grommet	2	RTA-RUBBERGROMMET
P	Bottom Door Hinge (preassembled on side panels)	2	RTAFRONTLVR/ RTAFRONTLVL
Q	Door Magnet (preassembled inside of doors)	2	RTAMAGNET

## MAINTENANCE AND CARE

- Periodically check to make sure the beams tabs are secure into the slots of the side panels.
- Use a dry or slightly dampened, clean cloth to wipe down the cabinet if needed.

## CUSTOMER FEEDBACK SURVEY

Scan the QR code below to take a short survey about this product.





EDSAL MANUFACTURING CO, LLC | 1555 W. 44TH STREET | CHICAGO, IL 60609 | [www.edsal.com](http://www.edsal.com)